

A Sustainable Precinct by SLA North Wright

STAGE 1

Home 4a offers a flexible, multi-functional floorplan. North-facing orientation, raked ceilings and high-set windows maximise natural light and airflow. This compact, airtight design is extremely energy efficient to run, featuring a cleverly concealed European laundry. Central courtyard design and block landscaping maintains privacy, while street-facing elements promote passive surveillance.

Room To Grow

This floorplan has been designed to evolve to your future needs. Featuring flexible spaces, this clever design also allows for future extensions for a garage and an extra bedroom.

Levels	1
Bedrooms	2 + RTG
Bathrooms	1
Living Area	99m ²
Carport	18m ²

JOIN OUR COMMUNITY

[suburbanland.act.gov.au/
north-wright](http://suburbanland.act.gov.au/north-wright)

CALL US TODAY

1800 777 952



ACT
Government

Suburban Land
Agency

The Suburban Land Agency (SLA) makes no warranty regarding the accuracy or completeness of information in this publication and recommends obtaining independent legal, financial and accounting advice before considering purchasing. The plans, examples and information contained herein are for illustrative purposes only and should not, without further inquiry, be relied upon as to their ultimate accuracy. To the extent permitted by law, the SLA will not be responsible for any loss or damage that may be incurred as a result of your reliance upon these materials. Plans and rendered images copyright Suburban Land Agency.

HOME

4a

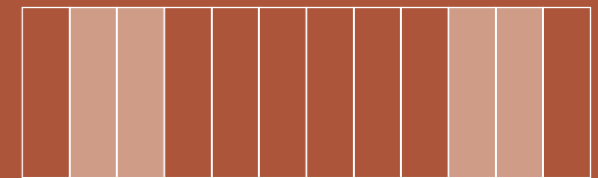
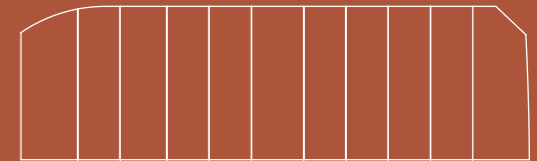

SINGLE LEVEL



2 BED + ROOM TO GROW



1 BATH



CARPORT



EER 7.7-8.2

The buyer is advised that any furniture shown is not included.
The buyer is advised that as construction is not yet complete,
variations to the floor plan may occur in accordance with the
First Grant Contract.

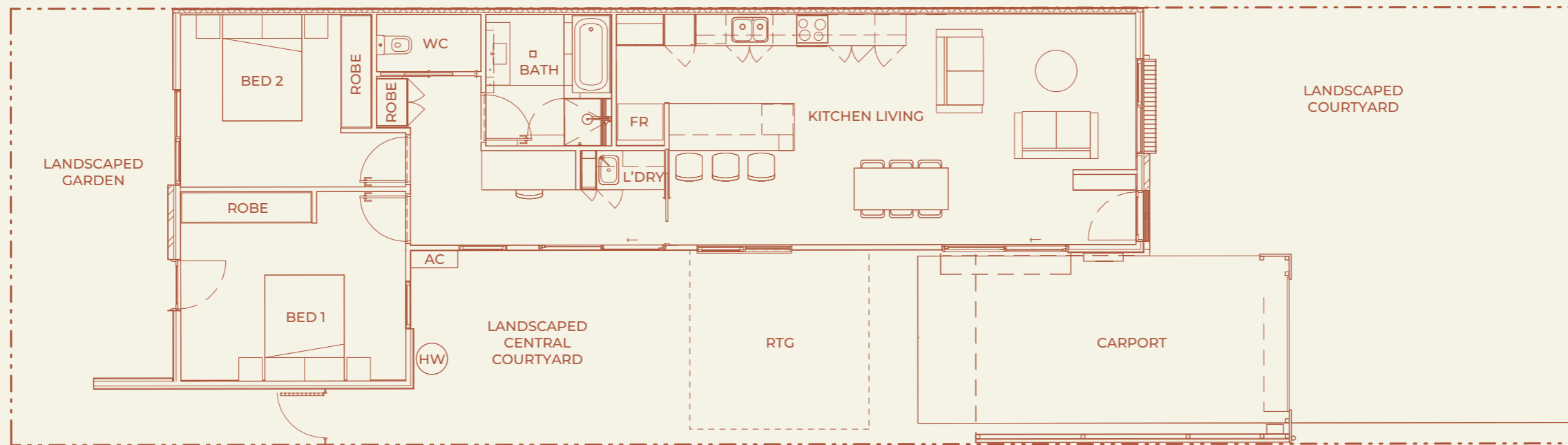
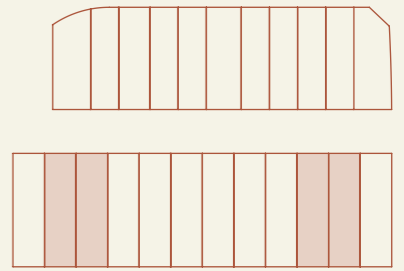

HOME 4a
SINGLE LEVEL, 2 BED + ROOM TO GROW

SCALE
1 : 100 @ A3

SECTION 55
BLOCKS 2, 3*, 10 AND 11*

Asterisk (*) indicates a
home with a mirrored plan