

Margaret Timpson Park Upgrades

Landscape Plan - INDICATIVE ONLY

KEY

Extent of Works

Offsets

EXISTING ELEMENTS

- Existing Drinking Fountain**
Drinking fountain to be retained
- Existing Pedestrian Crossing**
Pedestrian crossing over Benjamin Way, connecting the Belconnen Mall to Margaret Timpson Park
- Existing On-street Parking**
Loading zones, taxi zones, disabled and regular hour limit parking along Benjamin Way and Chandler Street
- Existing Grass Mound**
Retained existing grass mound
- Existing Seating**
Retained existing seating
- Existing Bins**
Existing bins to be retained
- Existing Art Installation**
Existing Art sculpture to be retained
- Park Entry Arch**
Existing landmark entry structure

PROPOSED ELEMENTS

- Pedestrian Path**
New path providing pedestrian access
- Accessible Ramp**
Accessible ramp to provide northern access from Chandler Street
- Public Toilet**
Site identified for single accessible cubicle toilet block
- Play Space Area with Softfall Rubber**
Hero piece Rope Pyramid, Springer, Tower Rope Spinner and Basket swing
- Picnic Area**
Picnic area with accessible table setting
- BBQ**
Electric BBQ
- Maintenance Access Upgrade**
Proposed maintenance access upgrades
- Proposed Trees**
New design trees
- Proposed Informal Seating**
Sandstone block seat

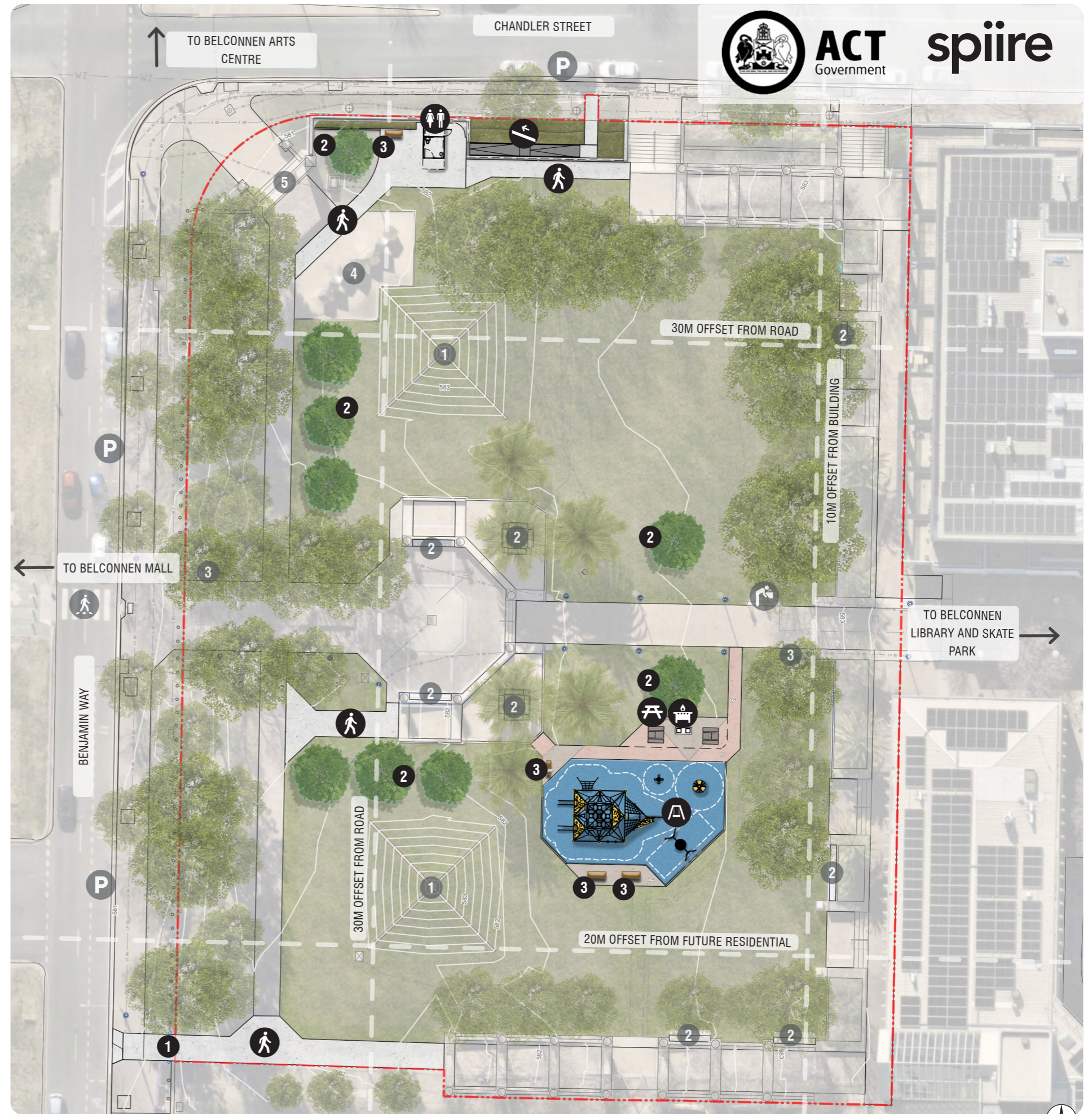

ACT
Government

spiire



Margaret Timpson Town Park Upgrades

Landscape Elevation Through Play Space - INDICATIVE ONLY



spiire

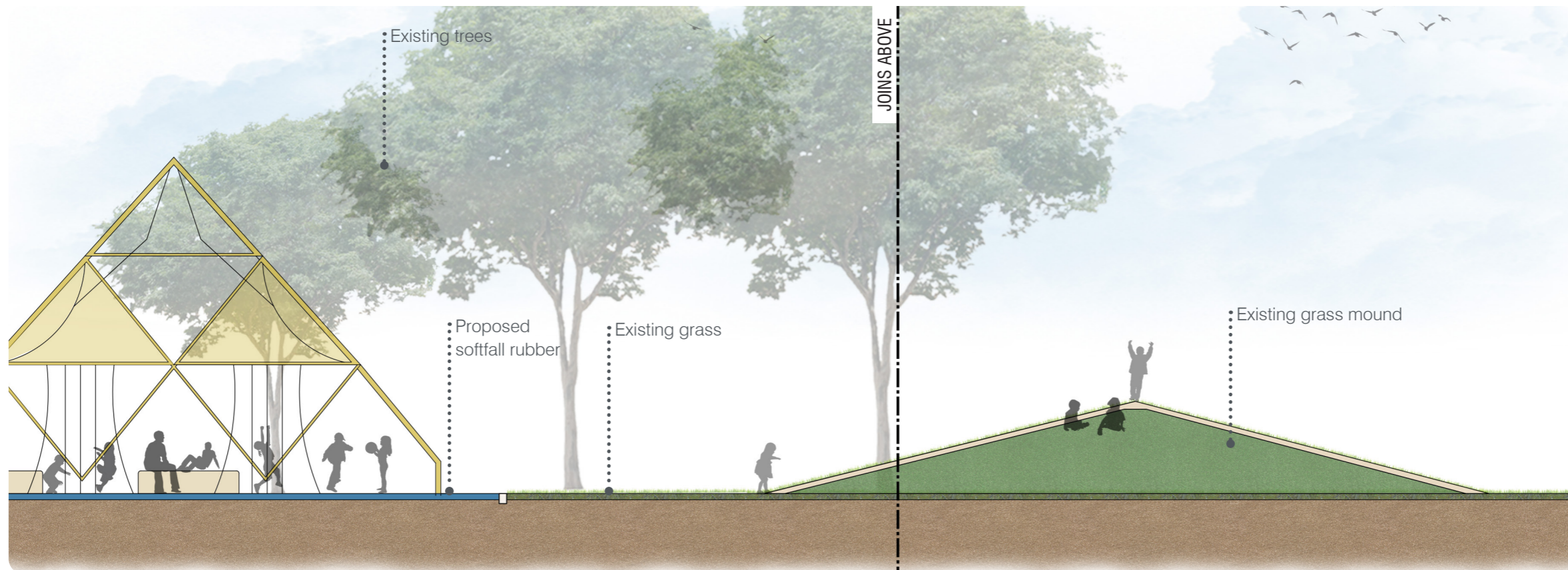
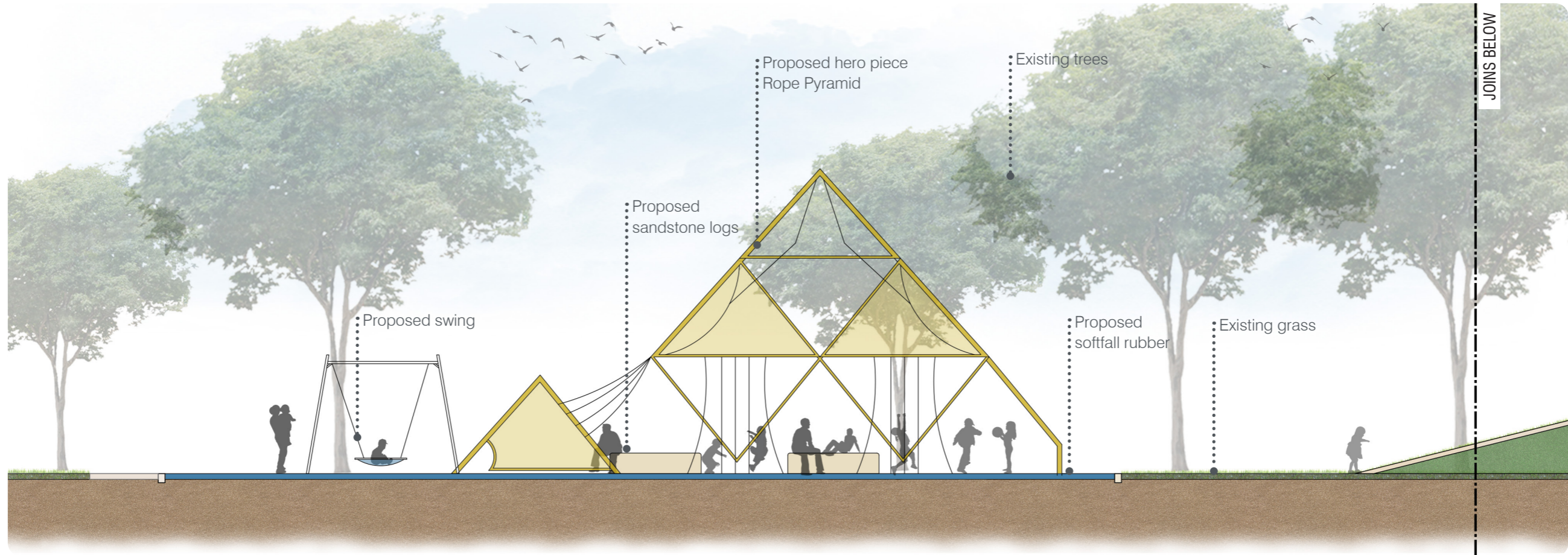

Margaret Timpson Town Park Upgrades

Landscape Elevation Through Toilet Block and Access Ramp - INDICATIVE ONLY



spiire

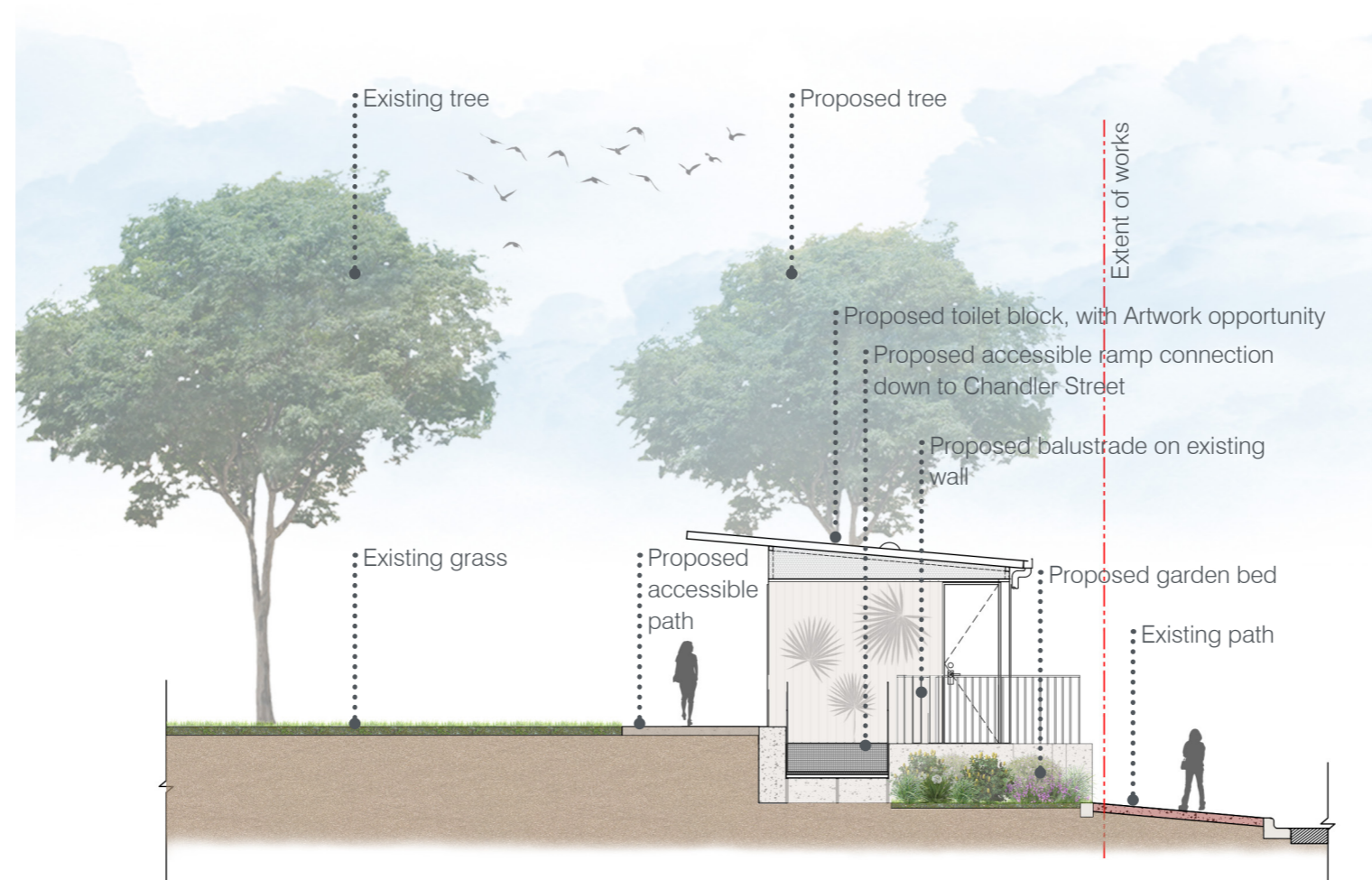

Margaret Timpson Town Park Upgrades

Proposed Indicative Materials and Equipment



ACT
Government

spiire

PROPOSED PLAY EQUIPMENT

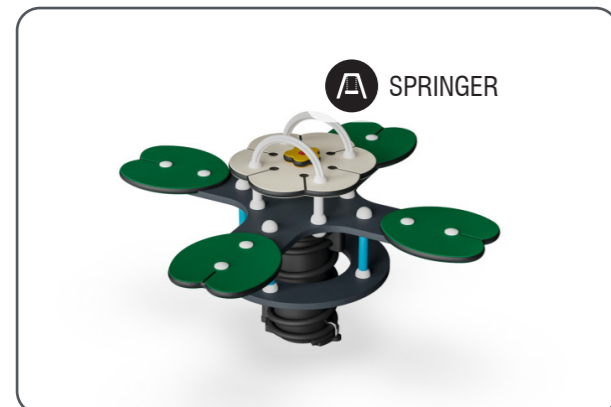
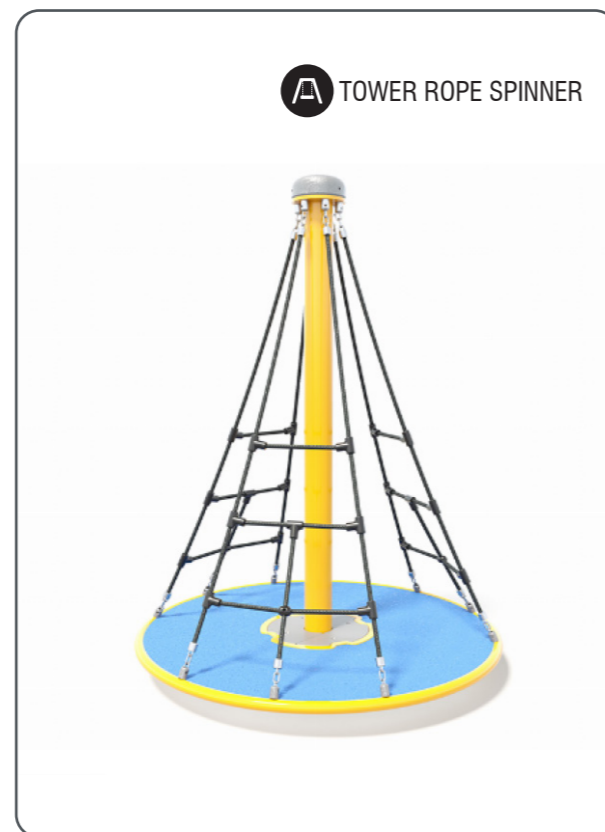
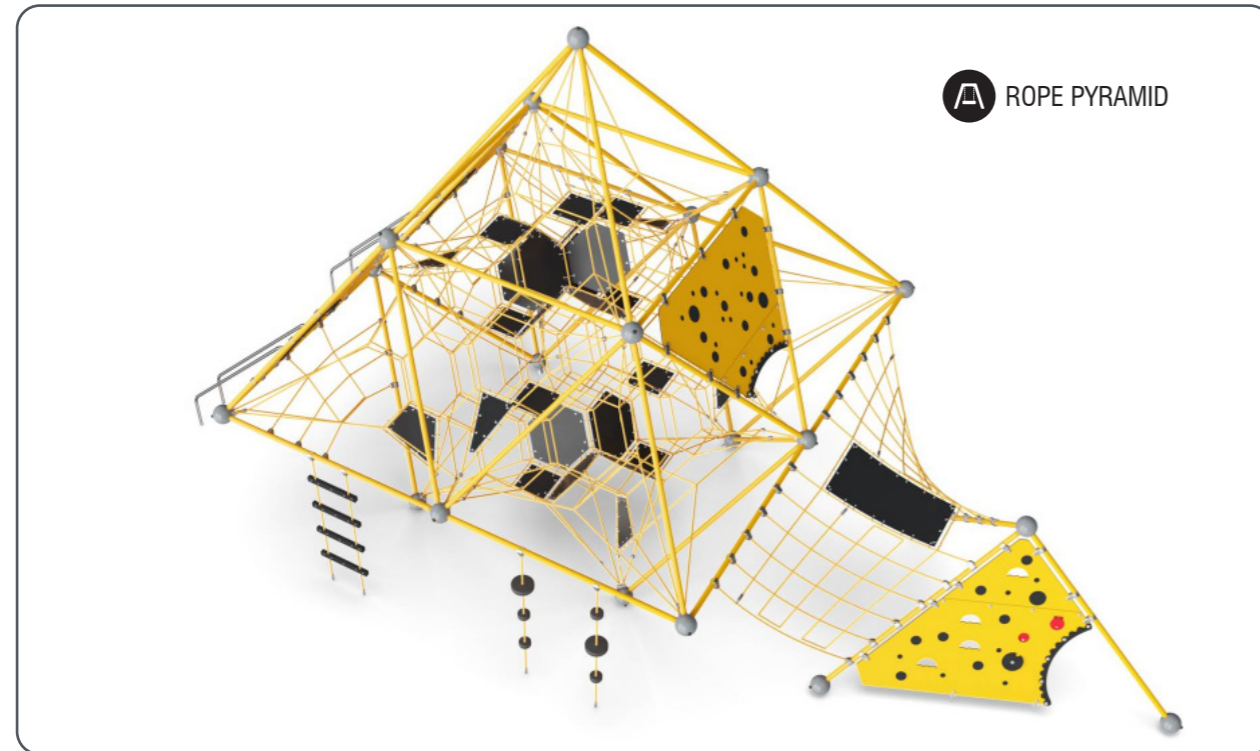

INDICATIVE FURNITURE AND AMENITY

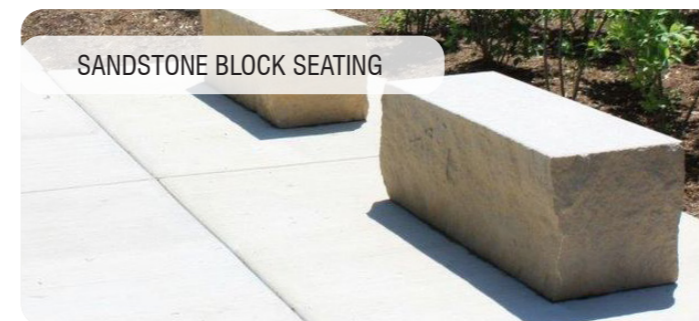

INDICATIVE FINISHES

